

CONSTRUCTION PLANS FOR
 INDIAN CREEK STREAMBANK STABILIZATION 319 PROJECT
 WOOD RIVER DRAINAGE AND LEVEE DISTRICT
 MADISON COUNTY, ILLINOIS

Date 09/19/2024
 Designed ME Andreas
 Drawn ME Andreas
 Checked Michael Andreas
 Approved Michael Andreas
 Michael Andreas
 Andreas Consulting Services
 IL

COVER SHEET
 WOOD RIVER DRAINAGE AND LEVEE DISTRICT
 Indian Creek 319 W/S Project
 Madison County, IL

Andreas Consulting Services
 21 Belmont Pl
 Maryville, IL 62062
 618-792-0748
 File No. WRDLD Cover Sheet.dwg
 Drawing No. **COVER**

INDEX TO SHEETS

COVER SHEET

- C101 PLAN VIEW INDIAN CREEK PHOTOBASE
- C102 PLAN VIEW INDIAN CREEK CONTOUR MAP
- C201 PROFILE INDIAN CREEK RIPRAP PLACEMENT
- C301 CROSS SECTIONS STA 0+45 & 1+00
- C302 CROSS SECTIONS STA 1+45 & 1+90
- C303 CROSS SECTIONS STA 2+30 & 2+63

| MATERIALS | |
|----------------------|------------|
| ITEM | QUANTITY |
| A-4 ROCK RIPRAP FACE | 1110 TON |
| GEOTEXTILE FABRIC | 1310 SQYD |
| SEEDING & MULCHING | 0.26 ACRES |

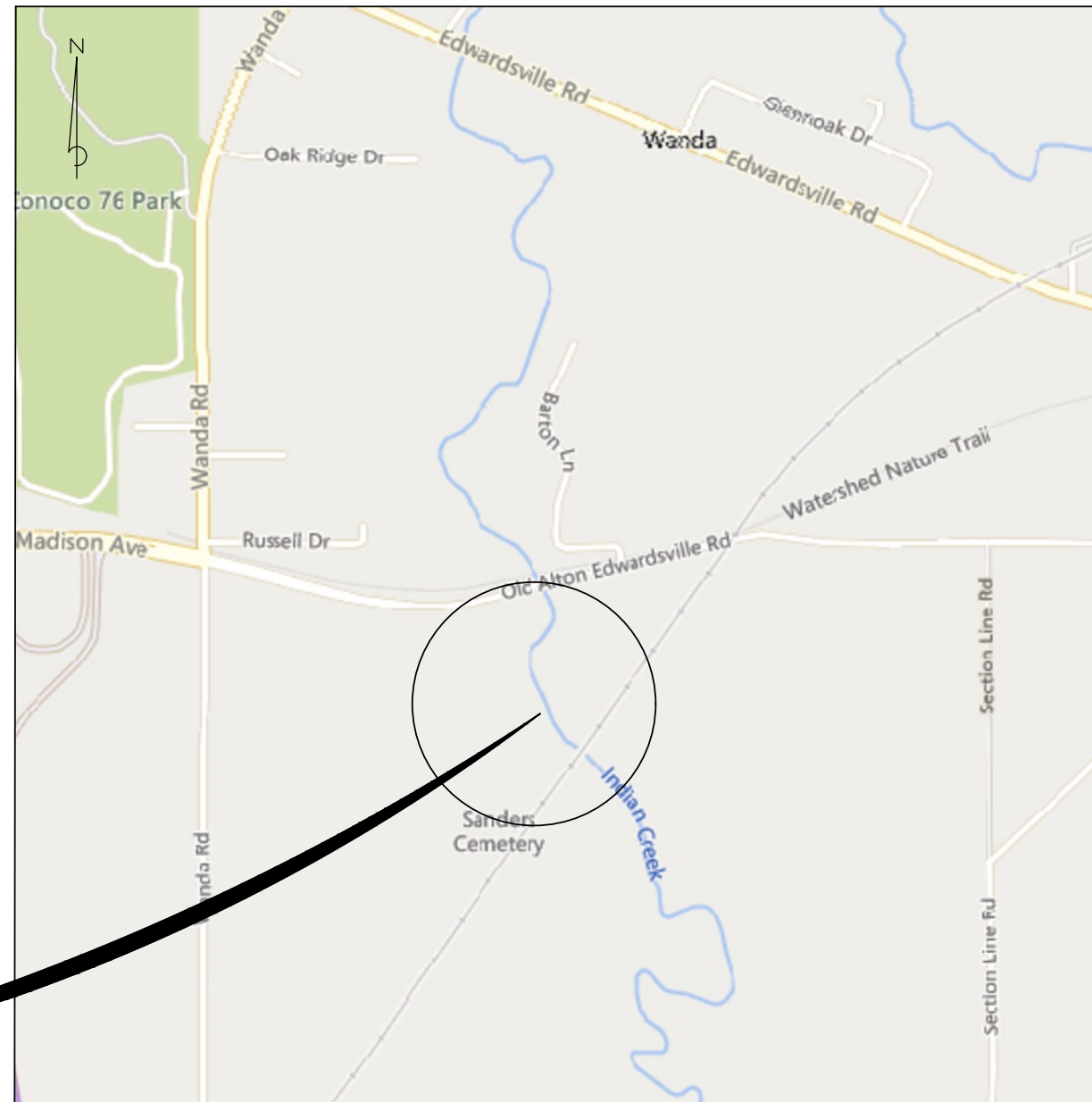

SITE

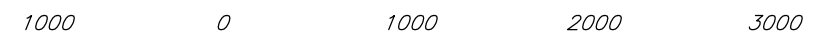

Scale in Feet

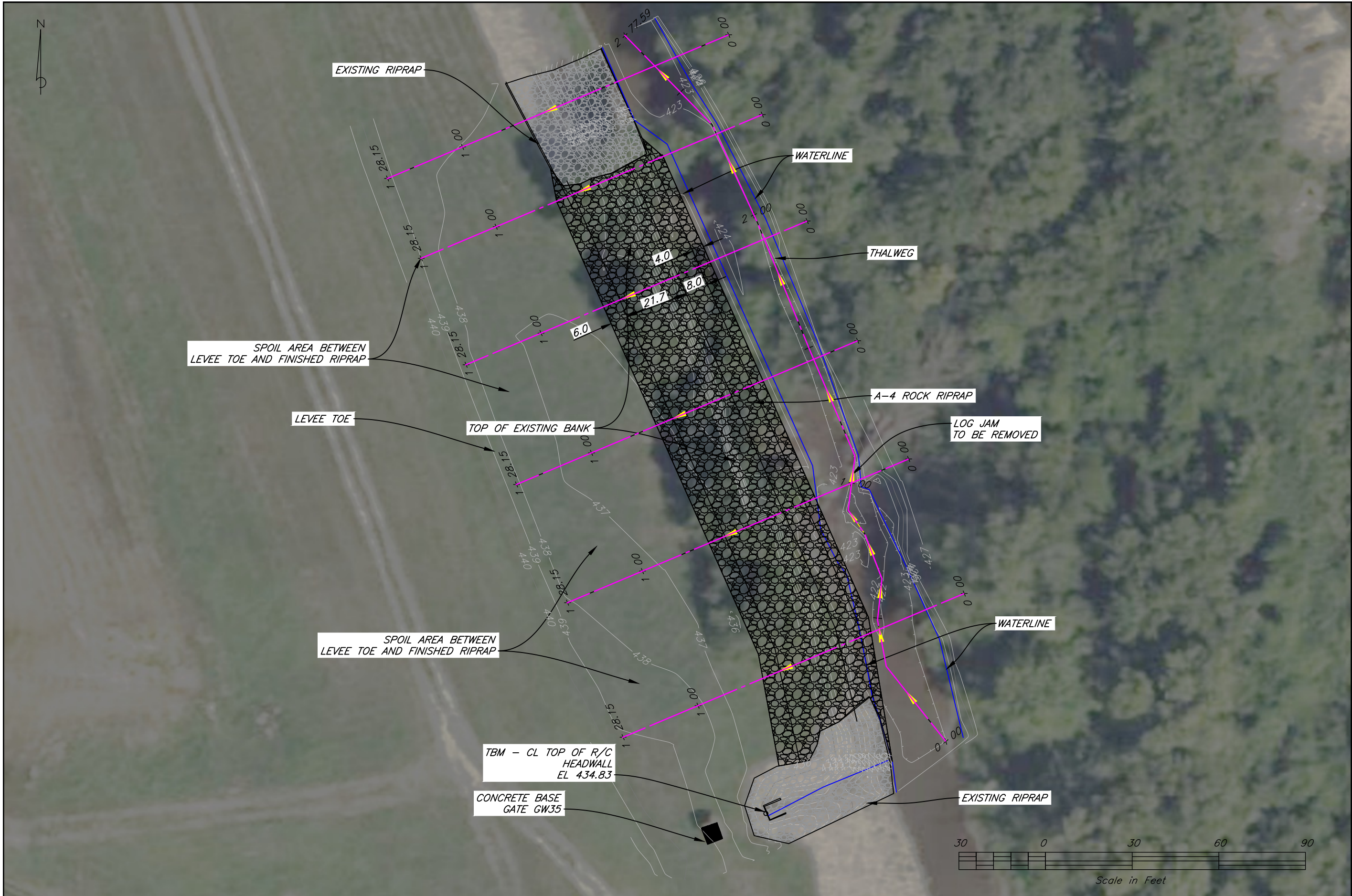

| | | | |
|----------|------------|----------|------------|
| Designed | ME Andreas | Date | 09/15/2024 |
| Drawn | ME Andreas | Checked | _____ |
| | | Approved | _____ |

Site Plan View Photobase
 Streambank Stabilization
 Wood River Drainage & Levee District
 Indian Creek W/S 319 Project
 Madison County, IL

Andreas Consulting Services
 21 Belmont Pl
 Maryville, IL 62062
 618-792-0748

File No.
 WRD&DL.dwg
 Drawing No.
C101

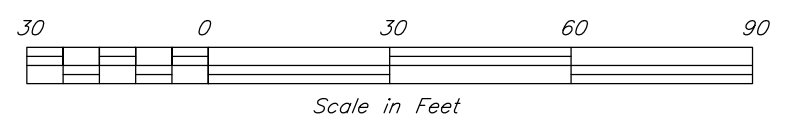
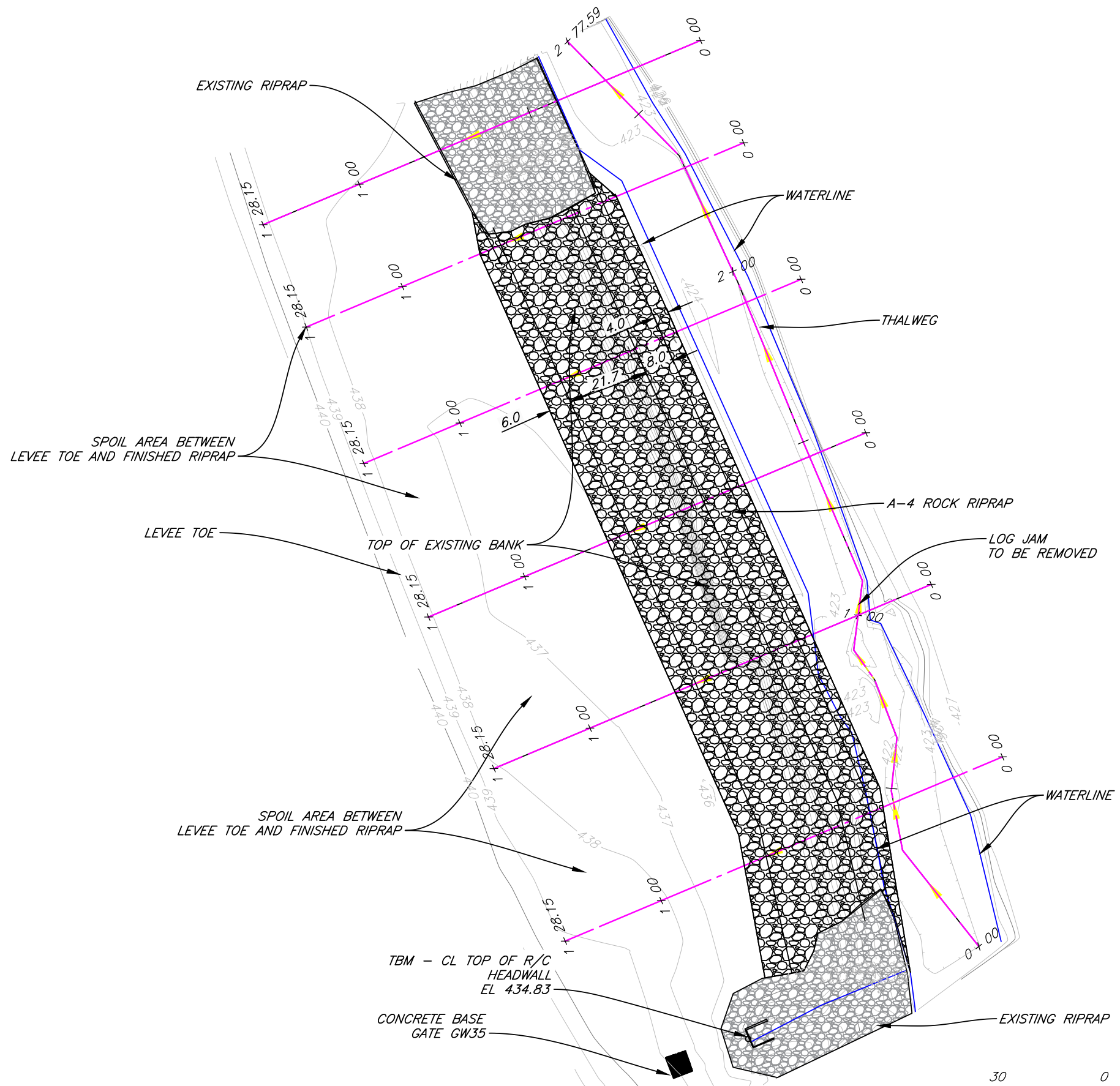

| | | | |
|----------|------------|----------|------------|
| Designed | ME Andreas | Date | 09/15/2024 |
| Drawn | ME Andreas | Checked | |
| | | Approved | |

Site Plan View
Streambank Stabilization & Levee District
Wood River Drainage & Levee District
Indian Creek W/S .319 Project

Andreas Consulting Services
 21 Belmont Pl
 Maryville, IL 62062
 618-792-0748

File No.
 WRD&DL.dwg
 Drawing No.
C102

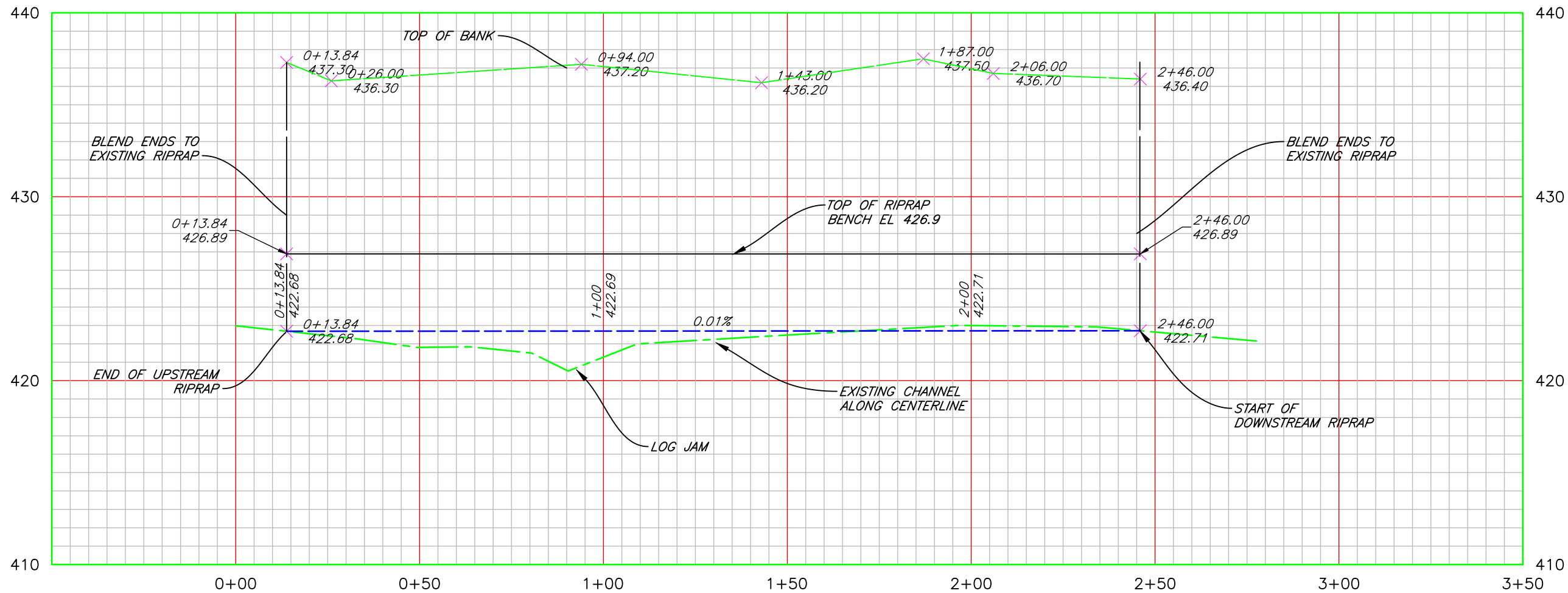

Alignment – CL Indian Creek PROFILE

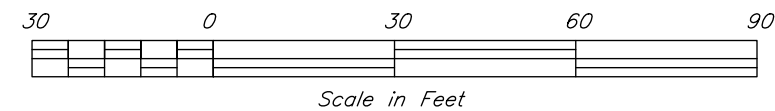

| | | | |
|----------|------------|----------|------------|
| Designed | ME Andreas | Date | 09/10/2024 |
| Drawn | ME Andreas | Checked | |
| | | Approved | |

Channel & Bank Profile
Streambank Stabilization
Wood River Drainage & Levee District
Indian Creek W/S 319 Project
Madison County, IL

Andreas Consulting Services
 21 Belmont Pl
 Maryville, IL 62062
 618-792-0748

| | |
|-------------|-------------|
| File No. | WRD&DL.dwg |
| Drawing No. | C201 |

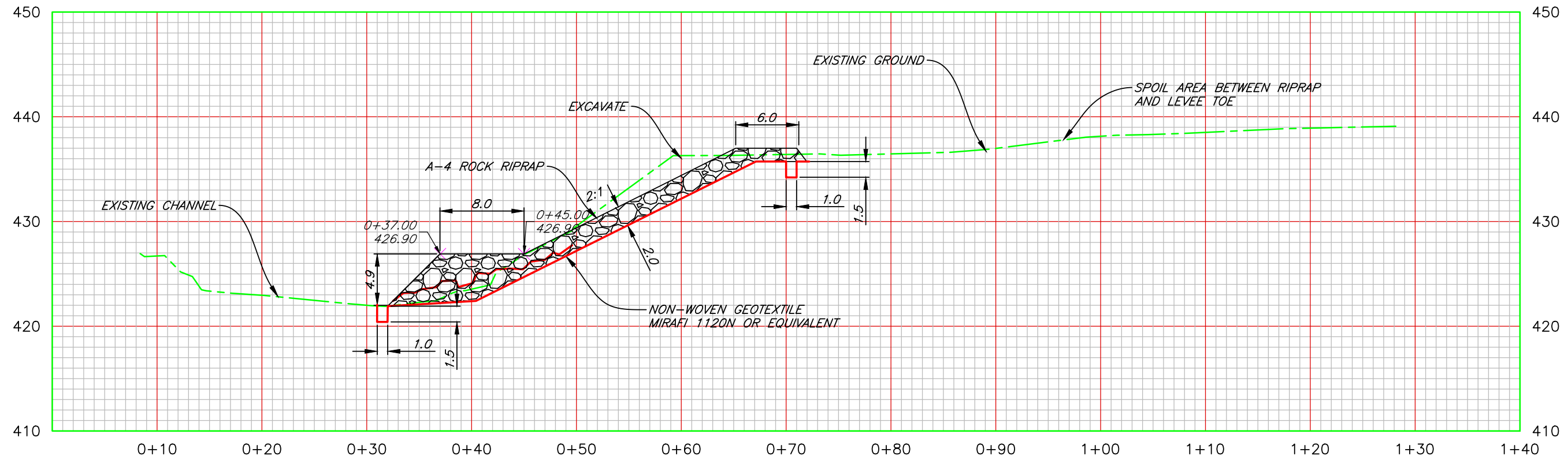

Alignment - Sta 0+45 PROFILE

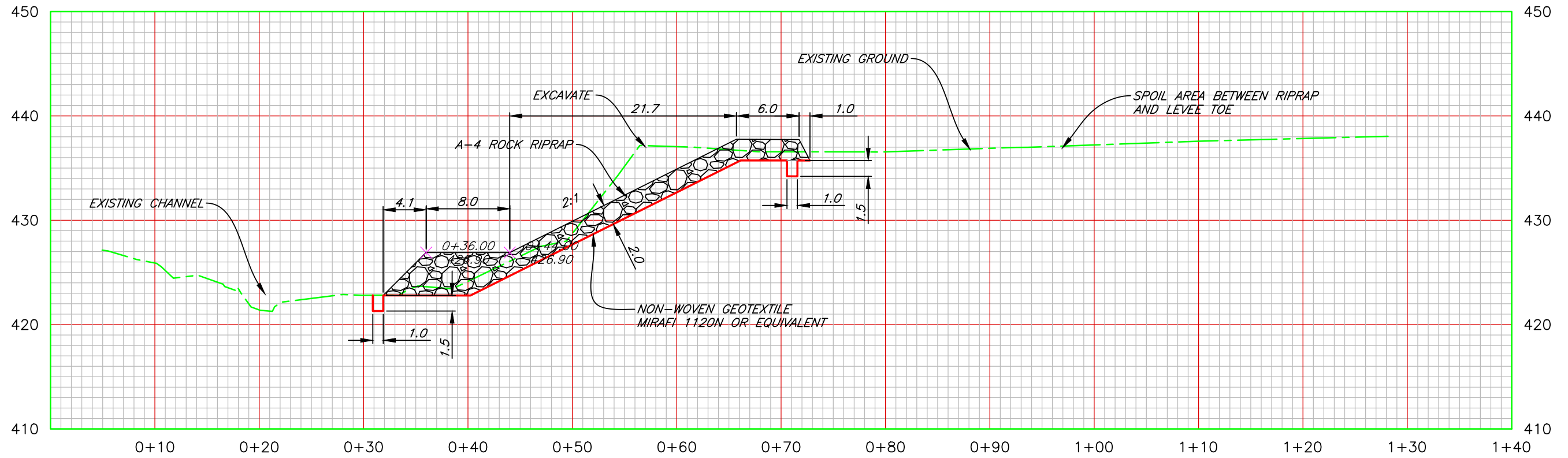

Alignment - Sta 1+00 PROFILE

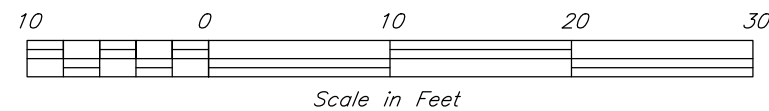

Date: 09/10/2024
 Designed: ME Andreas
 Drawn: ME Andreas
 Checked: _____
 Approved: _____

Cross Sections Sta 1+45 & 1+00
 Streambank Stabilization Indian Creek
 Wood River Drainage & Levee District
 Indian Creek W/S 319 Project
 Madison County, IL

Andreas Consulting Services
 21 Belmont Pl
 Maryville, IL 62062
 618-792-0748

File No. WRD&DL.dwg

Drawing No. C301

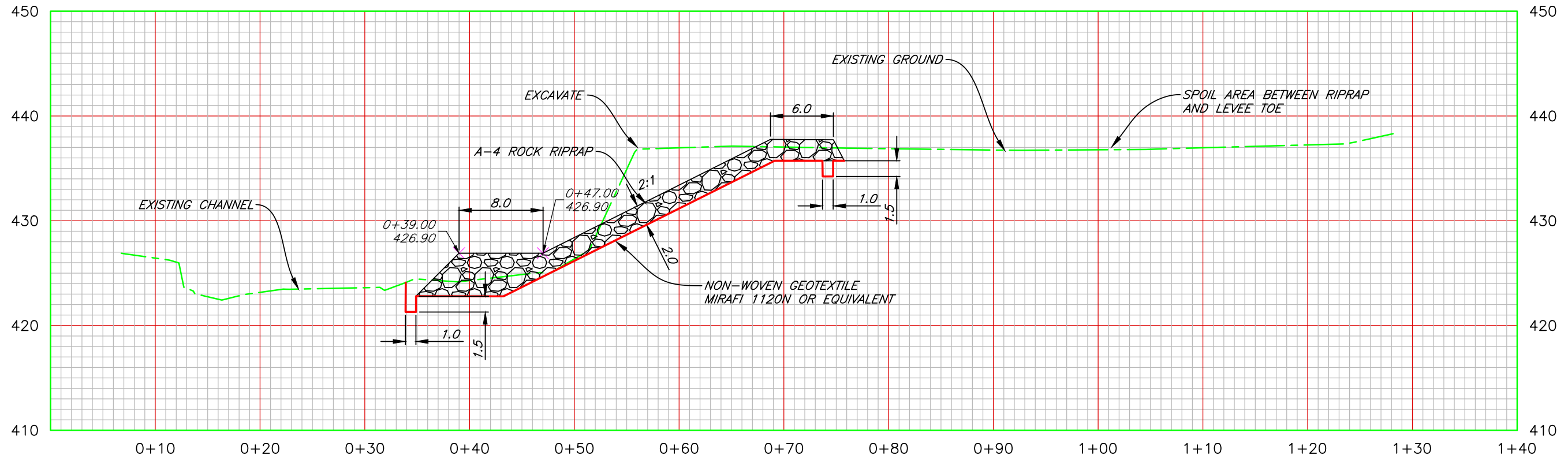

Alignment - Sta 1+45 PROFILE

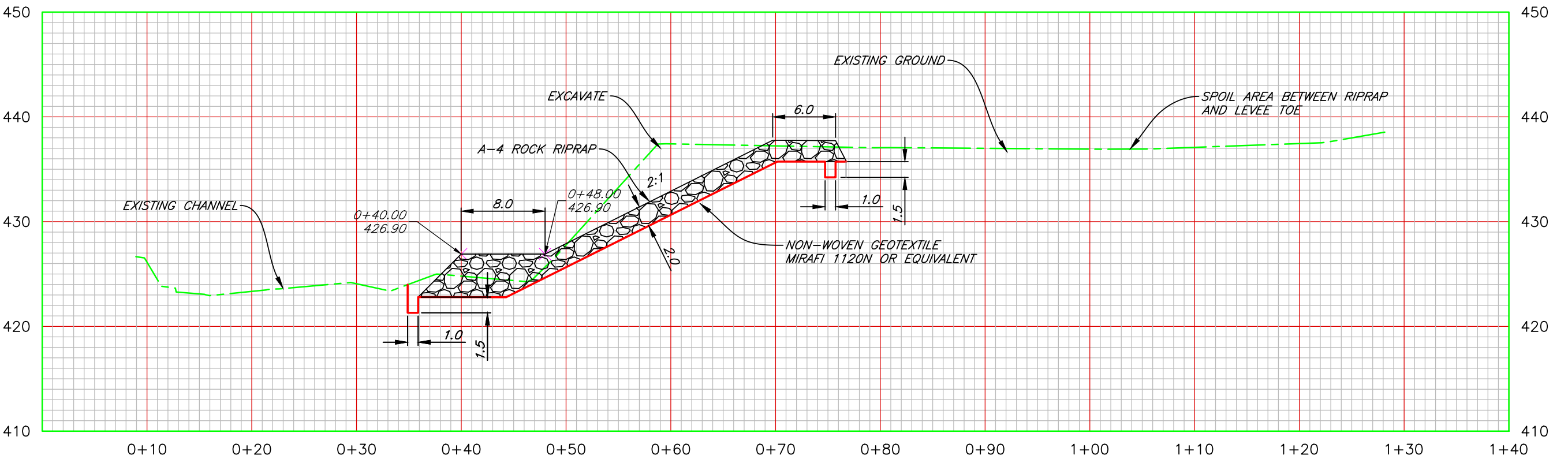

Alignment - Sta 1+90 PROFILE

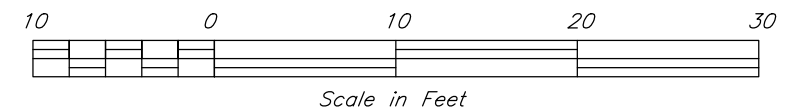

Date 09/10/2024
 Designed ME Andreas
 Drawn ME Andreas
 Checked
 Approved

Cross Sections Sta 1+45 & 1+90
 Streambank Stabilization Indian Creek
 Wood River Drainage & Levee District
 Indian Creek W/S 319 Project
 Madison County, IL

Andreas Consulting Services
 21 Belmont Pl
 Maryville, IL 62062
 618-792-0748

File No. WRD&DL.dwg

Drawing No. C302

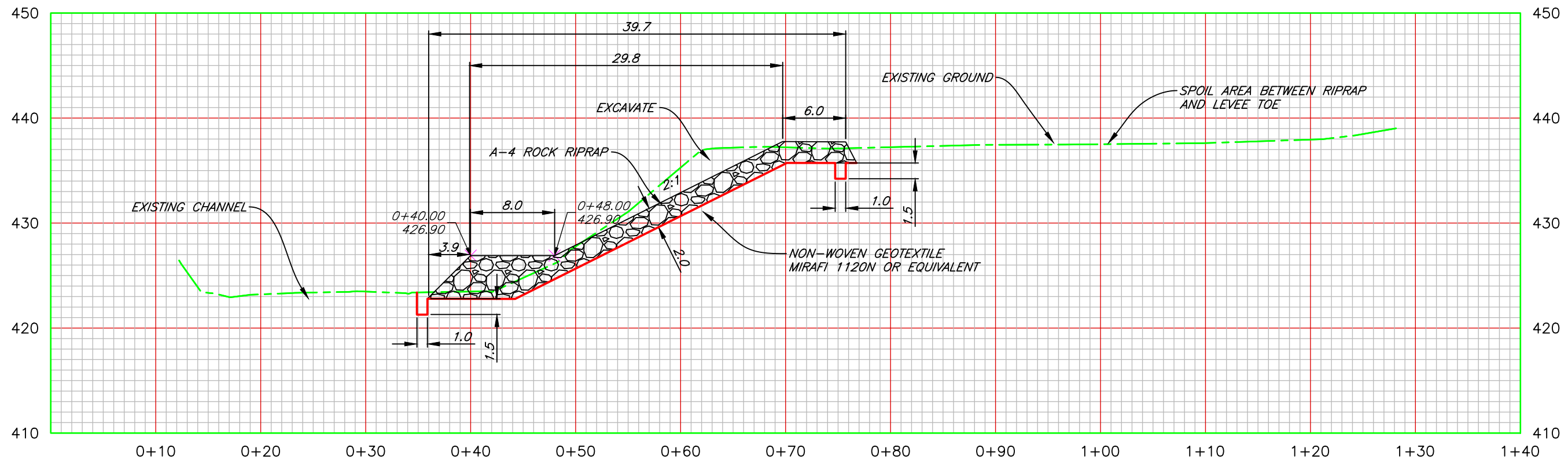

Alignment - Sta 2+30 PROFILE

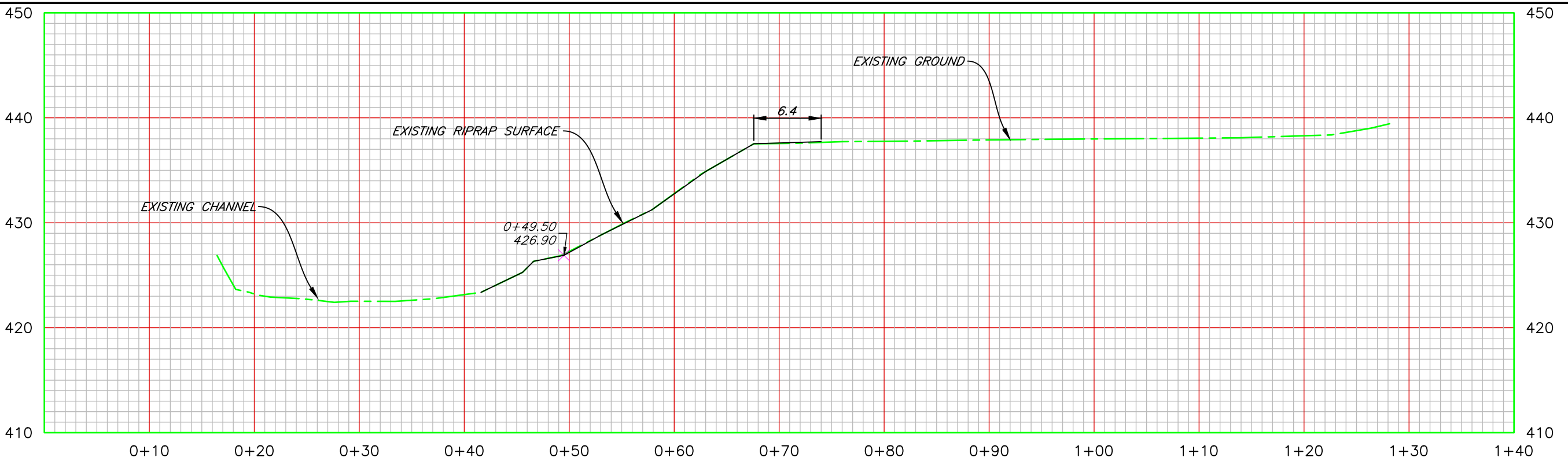

Alignment - Sta 2+63 PROFILE

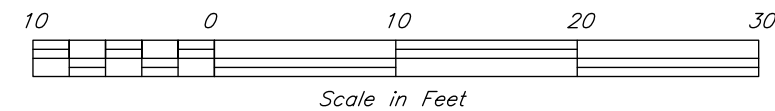

Date 09/10/2024
 Designed ME Andreas
 Drawn ME Andreas
 Checked
 Approved

Cross Sections Sta 2+30 & 2+63
 Streambank Stabilization Indian Creek
 Wood River Drainage & Levee District
 Indian Creek W/S 319 Project
 Madison County, IL

Andreas Consulting Services
 21 Belmont Pl
 Maryville, IL 62062
 618-792-0748

File No. WRD&DL.dwg
 Drawing No. C303